



**RW111 ARCH WITH
SINGLE MANIFOLD
DOCUMENT #EPL-46-R00-10-000-00
#EPL-46-R00-01-000-00**



90 Welham Road, Barrie, Ontario 705-722-7649

TITLE RW111 WITH ONE MANIFOLD		
PART NO EPL-46-R00-10-000-00	DWG NO EPL-46-R00-10-000-00	REV A
DATE: MAY 8, 2006	SHEET 1 OF 5	

MacNeil Wash Systems- Parts List

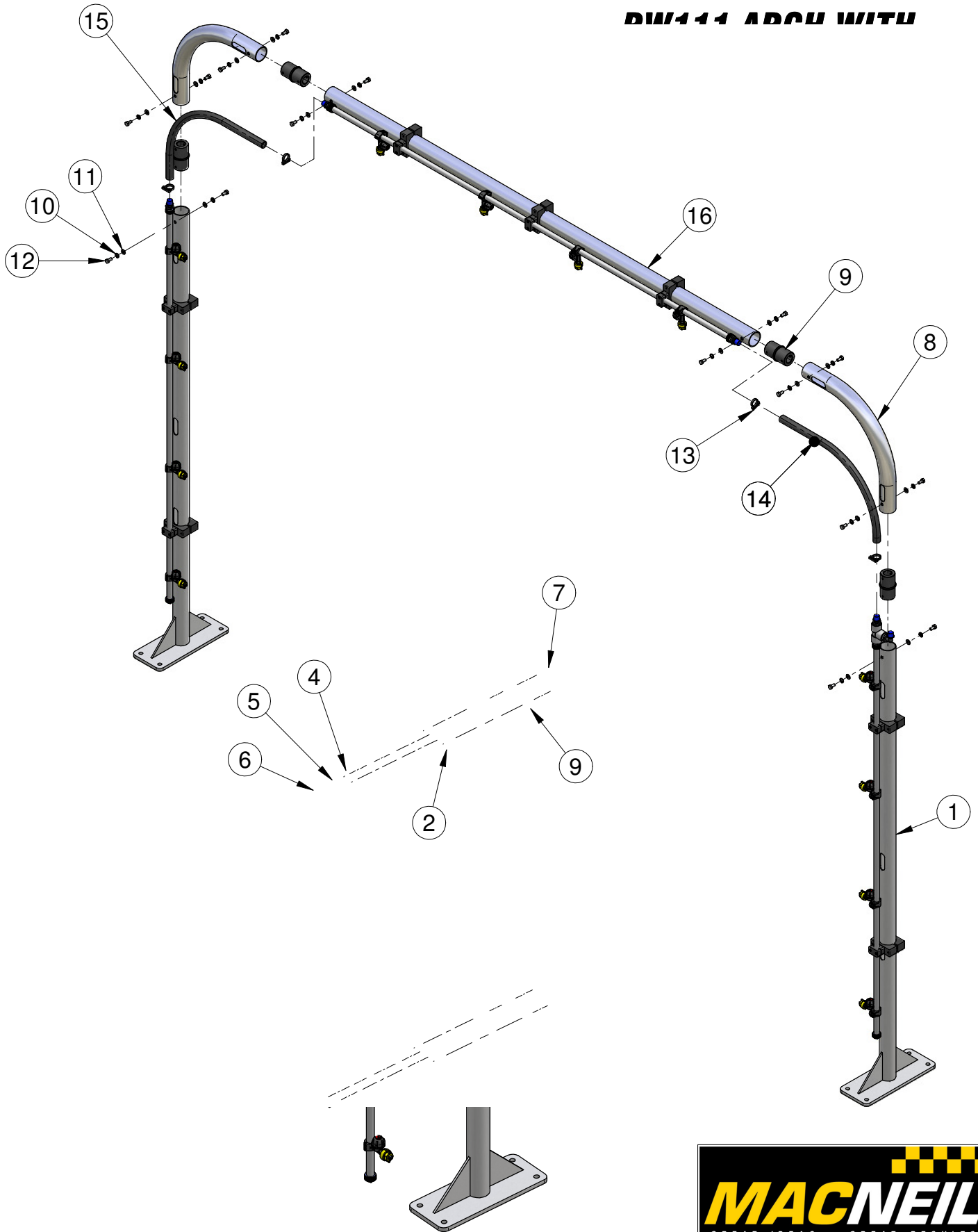

90 Welham Road, Barrie, Ontario 705-722-7649

TITLE RW111 WITH ONE MANIFOLD		
PART NO EPL-46-R00-10-000-00	DWG NO EPL-46-R00-10-000-00	REV A
DATE: MAY 8, 2006		SHEET 2 OF 5

MacNeil Wash Systems- Parts List

RW111 ARCH WITH NIFOLD

1-000-00

1-000-00

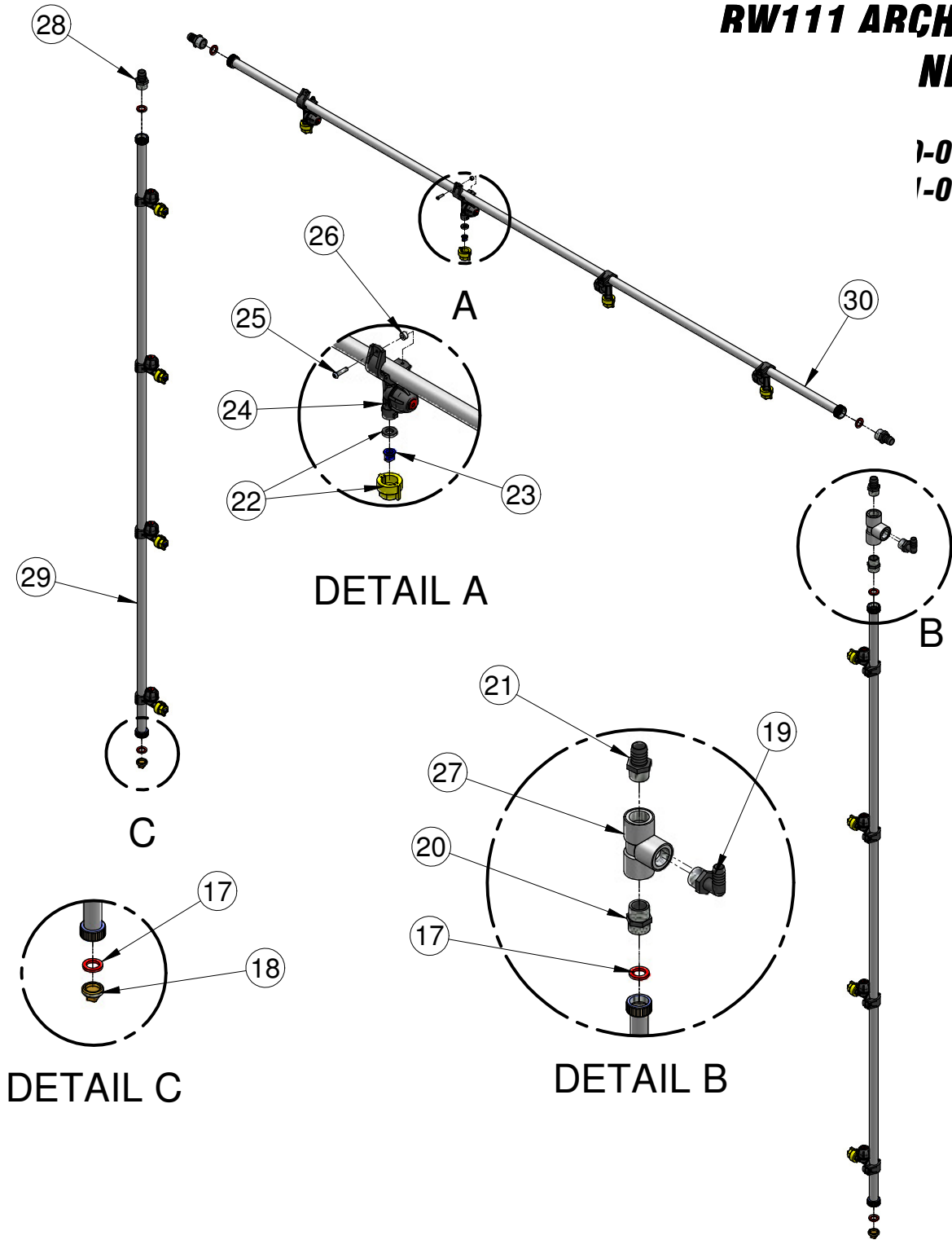

90 Welham Road, Barrie, Ontario 705-722-7649

TITLE RW111 WITH ONE MANIFOLD		
PART NO EPL-46-R00-10-000-00	DWG NO EPL-46-R00-10-000-00	REV A
DATE: MAY 8, 2006	SHEET 3 OF 5	

MacNeil Wash Systems- Parts List

**RW111 ARCH WITH
SINGLE MANIFOLD
DOCUMENT #
EPL-46-R00-10-000-00
EPL-46-R00-01-000-00**

REF.	DESCRIPTION	PART NUMBER	QTY.
1	VERTICAL POST	46-500-10-SG	2
2*	CLAMP PRE-SOAK ARCH	46-500-50-BK	7
3*	CLAMP THREADED PRE-SOAK ARCH	46-500-51-BK	7
4*	HOSE BLCK SNGL CSHN PAIR 1/2"PIPE	90-153-01-PP	7
5*	WSHR SS FLAT SMALL-OD 1/4"	80-304-000-SI	14
6*	SHCS SS 1/4"-20 x 1-1/2"	82-704-024-SIC	14
7*	SHCS SS 1/4"-20 x 1-3/4"	82-704-028-SIC	14
8	CORNER ELBOW	46-500-20-SG	2
9	TUBE CONNECTOR	46-500-40-BK	4
10	LOCK WASHER 3/8" SS	80-906-000-SI	16
11	WASHER FLAT 3/8" SS	80-106-000-SI	16
12	HHCS SS 3/8"-16 X 3/4"	82-506-012-SIC	16
13	CLAMP HOSE 1"-1.125" HO-24 BLACK	52-040-00-PP	4
14	HOSE PVC IMPERIAL 3/4" GRAY HAW 28 1/2"	33-041-81-2GY	1
15	HOSE PVC IMPERIAL 3/4" GRAY HAW 32"	33-041-81-2GY	1
16	TOP BEAM	46-500-30-SG	1



90 Welham Road, Barrie, Ontario 705-722-7649		
TITLE RW111 WITH ONE MANIFOLD		
PART NO EPL-46-R00-10-000-00	DWG NO EPL-46-R00-10-000-00	REV A
DATE: MAY 8, 2006	SHEET 4 OF 5	

MacNeil Wash Systems- Parts List

**RW111 ARCH WITH
SINGLE MANIFOLD
DOCUMENT #
EPL-46-R00-10-000-00
EPL-46-R00-01-000-00**

REF.	DESCRIPTION	PART NUMBER	QTY.
17	WSHR GARDEN HOSE GHW-RED	90-202-00-PP	6
18	FTG PLUG 3/4"GHT 206-WP	90-063-00-PP	2
19	FTG ELB BKPLY HB-3/4"MNPT 90Deg 3EL34	52-520-02-PP	1
20	FTG ADPTR BKPLY 3/4"NPT-3/4"GHT 3E34	52-524-00-PP	1
21	FTG ADPTR BKPLY 3/4"NPT-3/4"HSBRB 3A34	10-100-04-PP	1
22	NOZZLE CAP & GASKET YLW	10-200-02-PP	12
23	NOZL TIP BLUE PLSTC 10F80CB	10-250-02-PP	12
24	NOZL ANTIDRIP BODY 1/2" 402745	10-200-01-PP	12
25	SCREW PHL PAN-HD SS #10-24 x 3/4"	83-510-012-SNC	12
26	SPACER NY 3/8 DIA 3/16"L #10 SP163	89-003-01-PP	12
27	FTG TEE 3/4"PVC SCH80 IPEX only THD	90-231-08-PP	1
28	FTG ADPTR BKPLY 3/4"HB-3/4"GHT 3D34	52-523-00-PP	3
29	71" WATER MANFLD SUBASS'Y	42-651-00-MP	2
30	84" WATER MANIFOLD SUBASS'Y	46-200-00-MP	1

NOTE:

NOZZLE # 10-250-02-PP - USED FOR FINAL RINCE OR SPOT FREE
NOZZLE # 10-250-01-PP - USED FOR DRYING AGENT OR SEALER WAX



90 Welham Road, Barrie, Ontario 705-722-7649		
TITLE RW111 WITH ONE MANIFOLD		
PART NO EPL-46-R00-10-000-00	DWG NO EPL-46-R00-10-000-00	REV A
DATE: MAY 8, 2006	SHEET 5 OF 5	

MacNeil Wash Systems- Parts List